



*Sacrificial Anodes*

---

# **Aluminum Heat exchanger Sacrificial Anodes**

Corrmit Technologies Ltd. is a manufacturer of sacrificial Aluminum anodes with different shapes, sizes and core configuration to meet clients’ specifications. Corrmit Anodes’ chemical composition is environmental friendly and conforms to the latest MIL and DNV standards. All products are tested and inspected prior to shipping. Our high purity products are suitable for industrial and marine applications including offshore structures, submarine pipelines, ship hulls and etc.

**Chemical Composition:**

Chemical composition of aluminum anode alloy is according to MIL and DNV standards. We offer two different types of anodes as follow:

- Cormit Al I
- Cormit Al II

Element	Cormit Al I	Cormit Al II (low voltage)
	Weight (percent)	Weight (percent)
Indium	0.014-0.020	<0.005
Gallium	0.02	0.092-0.110
Zinc	4.0-6.5	<0.15
Silicon	0.08-0.20	<0.1
Copper		<0.005
Iron		<0.08
Mercury		<0.0001
Tin		<0.001
Nickle		<0.005
Magnesium		<0.010
Manganese		<0.010
Bismuth		<0.002
Cadmium		<0.002
Titanium		<0.002
Lead		<0.002
Boron		<0.001
Aluminium	Remainder	Remainder

**Electrochemical properties:**

---

Our products have the right electrochemical properties to fulfill your requirements. Aluminum anode’s electrochemical performance data is provided as per below:

Electrochemical Performance	
Open Circuit Potential	(-) 1.05 V vs Ag/AgCl
Closed Circuit Potential	1150 A-Hr/lb. (2530 A-Hr/Kg.)
Capacity at 25 <sup>0</sup> C	1150 A-Hr/lb. (2530 A-Hr/Kg.)
Nominal efficiency	85%
Physical properties	
Alloy Density	0.098 lb/in <sup>3</sup> (2.71 gm/cm <sup>3</sup> )

**Quality Control**

---

Our inspection test plan covers every stage from the delivery of raw material to the production stage incorporating NACE, DNV, MIL and ISO standards.

Thanks to the high grade materials we produce high quality anodes with excellent properties which exceed our clients’ expectations. Every anode is weighed to ensure that we deliver the right one.

Our quality standards conform to the ISO-9001 international standards.

## Heat exchanger anodes:

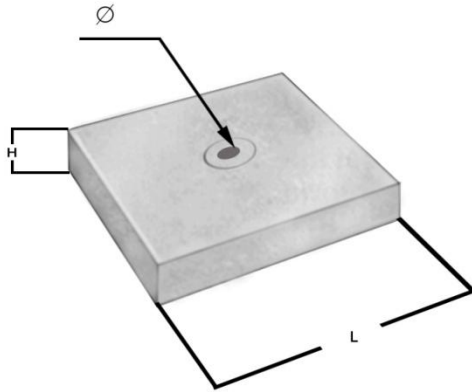

Dimension Code	Net Wt.		L		H		Φ in
	lbs	Kg	in	mm	in	mm	
Di1208	12.5	5.675	8	203.2	2	50.8	¾
Di2308	23	10.442	8	203.2	4	101.6	¾

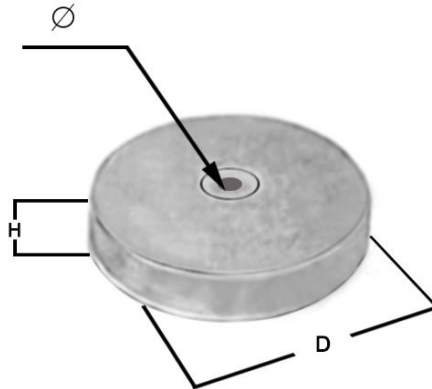

Dimension Code	Net Wt.		D		Φ In
	lbs	Kg	in	mm	
Di0305	3.5	1.59	5	127	¾

Company Address :110 Brew Street, Port Moody, British, Columbia, Canada, V3H0E4  
 Tel.: 1 604 910 7879  
 E-mail: [contact@corrmit.com](mailto:contact@corrmit.com)  
 Website: <http://www.corrmit.com/>

Ordering information				
<b>Chemical composition</b>				
Cormit Al I	<b>Type</b>			
Cormit Al II	HE	Heat exchanger anodes		
		<b>Shape</b>		
		05	Cube	
		06	Cylinder	
		<b>Dimension (mm)/ Dimension Code from our standard dimension table</b>		
		Please refer to Note 1		
Cormit Al II	HE	05	Di1208	Example

Note1: You may order your desired dimension from the following table or specify your custom dimensions based on your needs.

Note 2: We will use our standard pipe size in our products unless otherwise specified by clients.

Note 3: Please contact us with your custom specifications.